

Client: **MAC-UTI PROPERTIES Ltd.**  
 Project: **EXIM TOWER Office Building**  
 Location: **Ghana Avenue, Dar es Salaam, Tanzania**  
 Completion: **October 2009**  
 Floor Area: **12,000 m<sup>2</sup>**  
 Contract Cost: **US\$ 11.0 M**

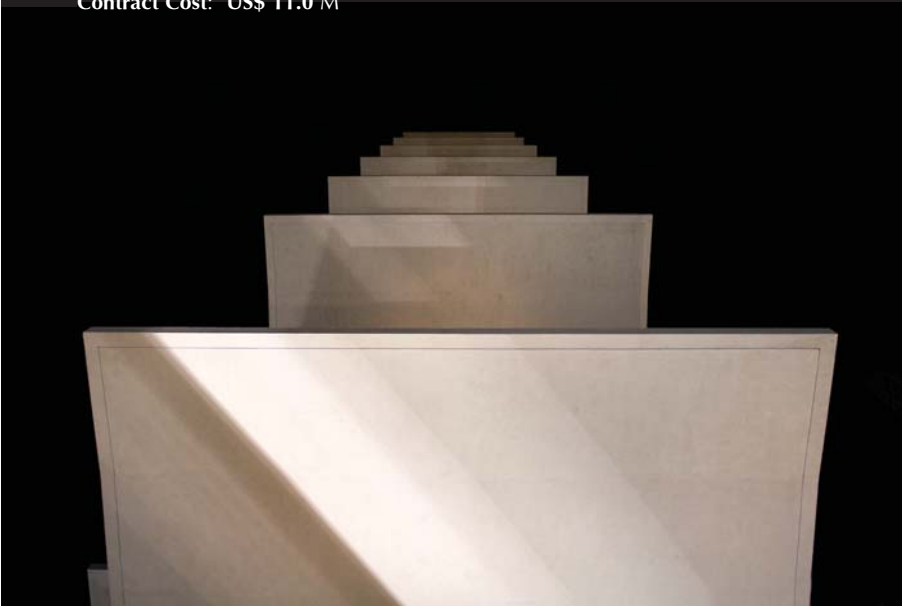

Front facade by night



New prestige office development comprising of 14 upper floors office space, ground and mezzanine level intended for bank occupancy and basement level car parking.

This project was initiated, with the concept design performed, by SPASM Design Architects in Mumbai, India. IPA Architects, Dar es Salaam, Tanzania, performed design development & documentation and construction supervision services as local co-architects.



Front facade / mesh screen

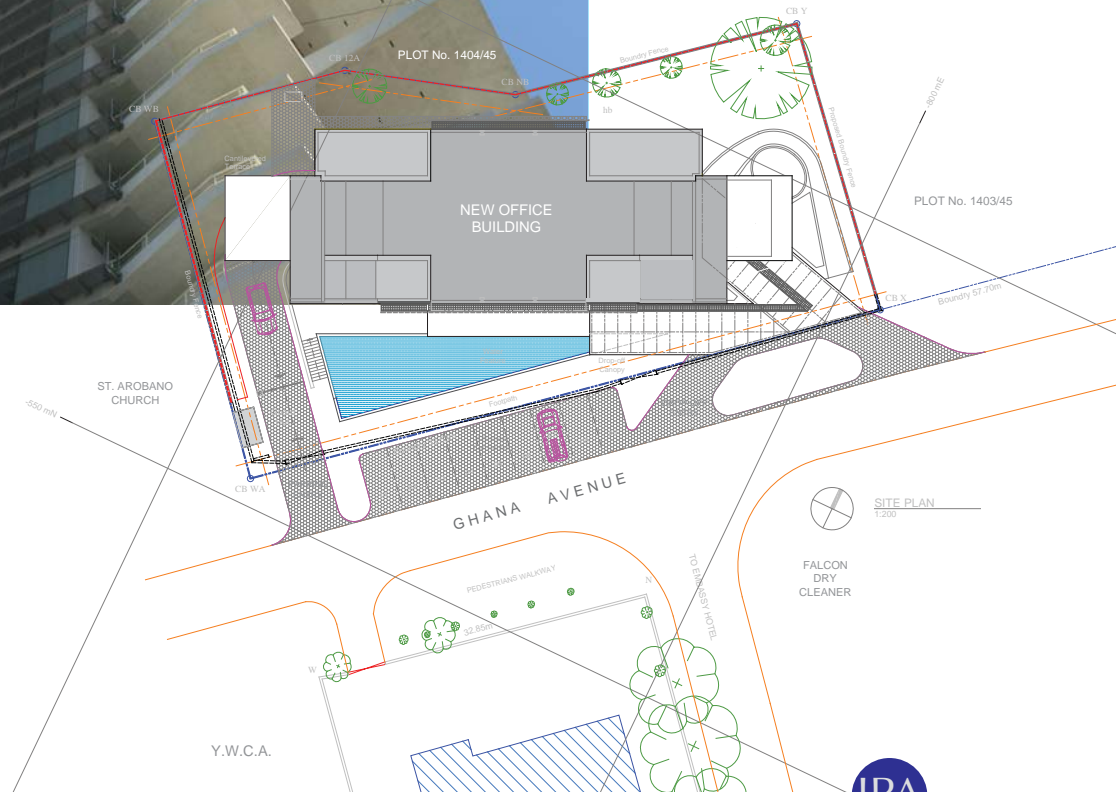

Office Building  
**EXIM TOWER**



Rear facade



Cantilevered terrace[s]



Mesh facade screen / gangway



Front facade / end terrace view



Entry canopy detail



Office Building  
EXIM TOWER

